

DACRYL®

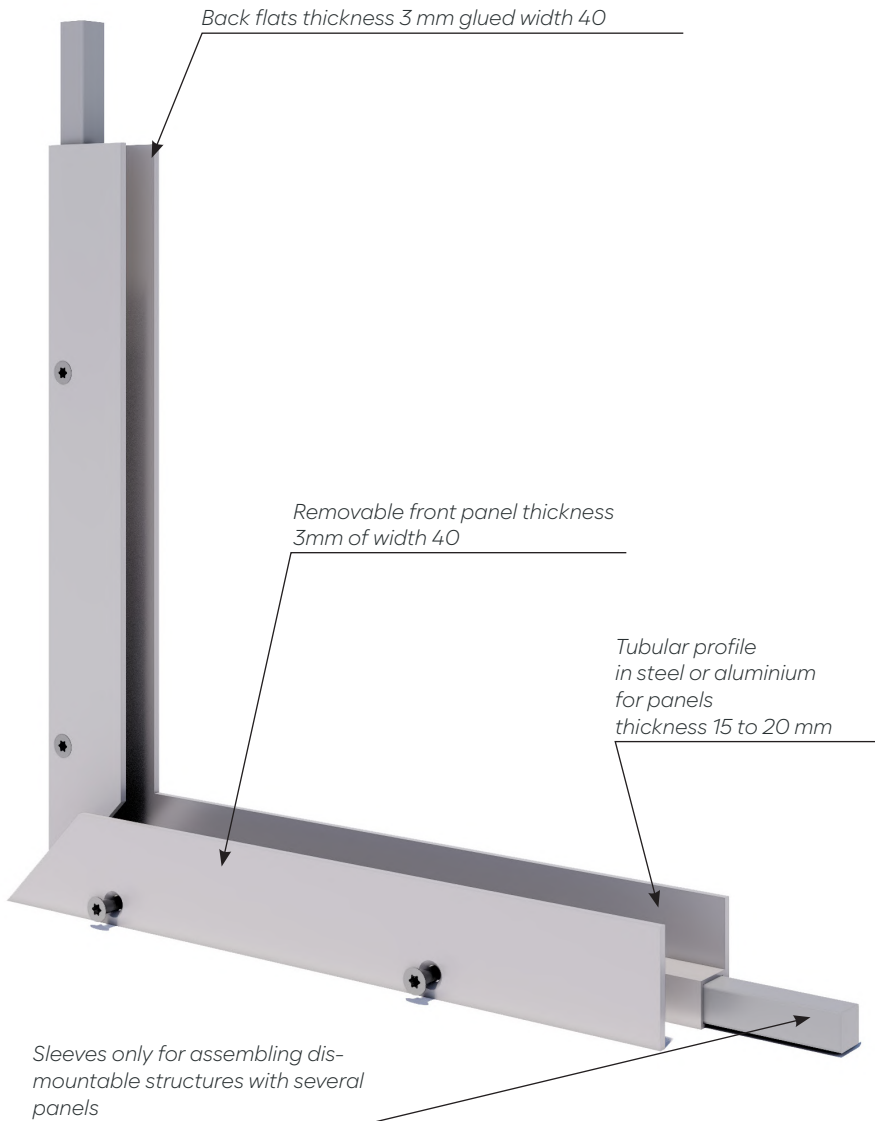

STRAIGHT TUBULAR FRAME:
SEVERAL PANELS
technical drawing D-A

TUBULAR SYSTEM: DETAILS AND FINISHES



Dimensions

• Square tubular structure in steel

for Dacryl® 15 mm thick:
16 × 16 mm

for Dacryl® th. 18 and 20 mm :
20 × 20 mm

• Square tubular structure aluminium or stainless steel (wet rooms)

20 × 20 mm only

• Closing dishes
width 40 mm / thickness 3 mm

• Finishing plates
width 20 mm / thickness 2 mm

Frame finishes

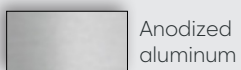

Anodized aluminum



Black RAL 9005 Epoxy



Grey epoxy RAL 7016

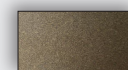

Anodic Bronze epoxy

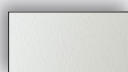

White RAL 9010 Epoxy



Gold Pearl epoxy

Other finishes on quotations



Clear Grey epoxy RAL 9006

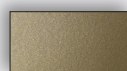

Steel Bronze epoxy

TUBULAR SYSTEM: DETAILS AND FINISHES

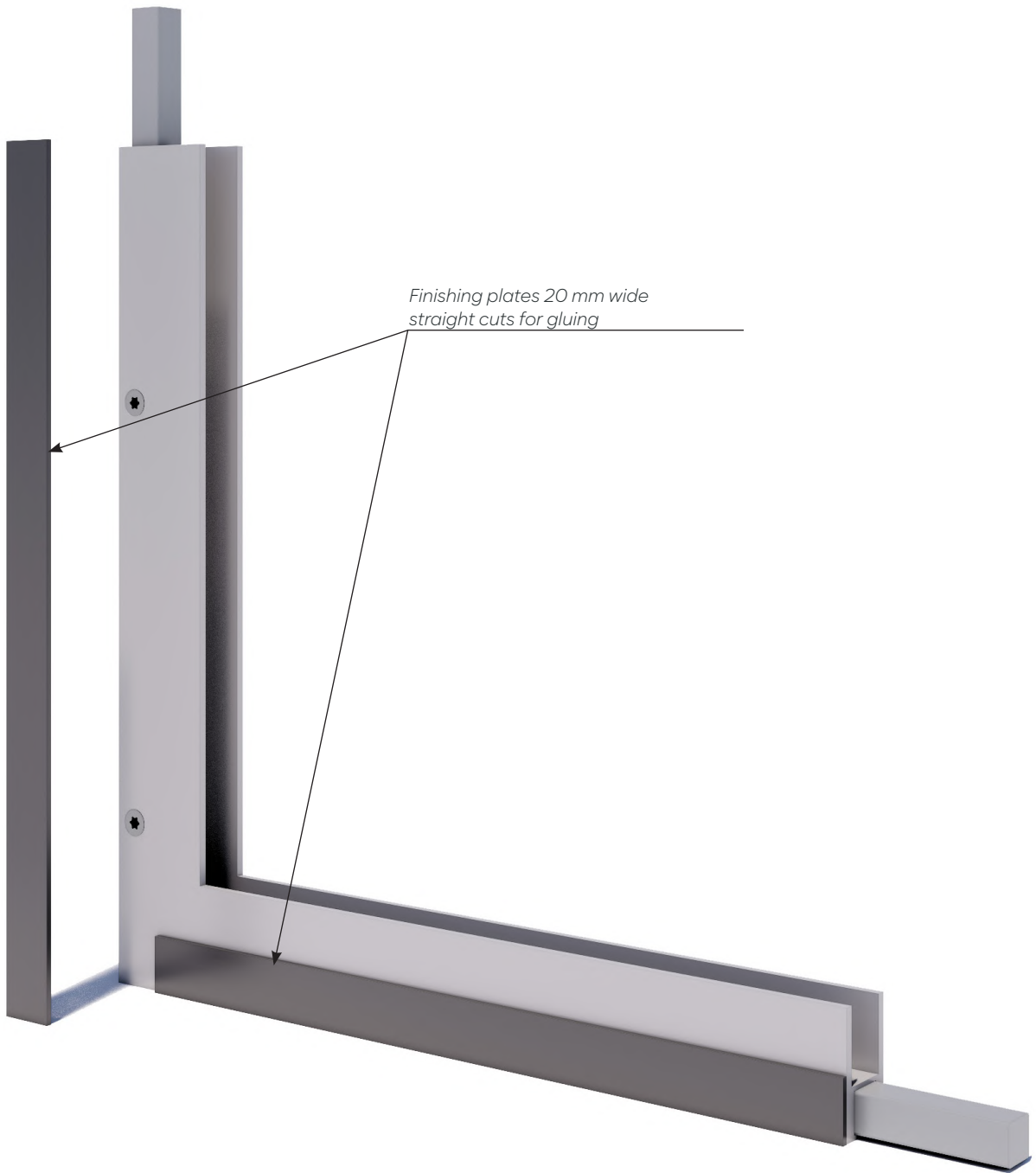

Finishing dishes

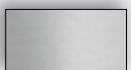

Anodized
aluminum



Black RAL
9005 Epoxy

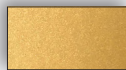

Gold Pearl
époxy

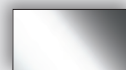

Stainless steel
Mirror polished

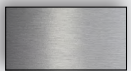

Brushed
aluminium

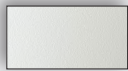

White
RAL 9010 Epoxy

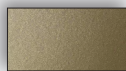

Steel Bronze
epoxy



Stainless steel
Brushed

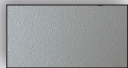

Clear Grey epoxy
RAL 9006

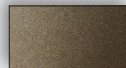

Anodic Bronze
epoxy

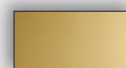

Brass
Polished

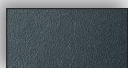

Grey epoxy
RAL 7016



Brass
Brushed

STRAIGHT TUBULAR FRAME: SEVERAL PANELS

Technical drawing ref. D-A



Straight tubular frame, finish: brass

Uses

- Partition wall straight / verse
- Impost
- Wall application

Bindings

- Floor - ceiling
- Floor - wall
- Wall sconce

Dimensions

• Square tubular structure in steel

for Dacryl® 15 mm thick: 16 × 16 mm

for Dacryl® th. 18 and 20 mm :
20 × 20 mm

• Square tubular structure aluminium or stainless steel (wet rooms)

20 × 20 mm only

• Closing dishes

width 40 mm / thickness 3 mm

• Finishing plates

width 20 mm / thickness 2 mm

Deliverables

Delivered dismantled:

- Dacryl® panels with protections
- Dismantled tubular frame:
2 verticals + 2 horizontals uprights
+ closing plates (screws supplied)
- LED lighting with welded wire outlet, in roll ready to lay and connect
- Power supply 220 V for 12v/24v LED lighting
- Finishing dishes delivered separately, ready to glue

STRAIGHT TUBULAR FRAME: SEVERAL PANELS

Technical drawing ref. D-A

Description of deliverables

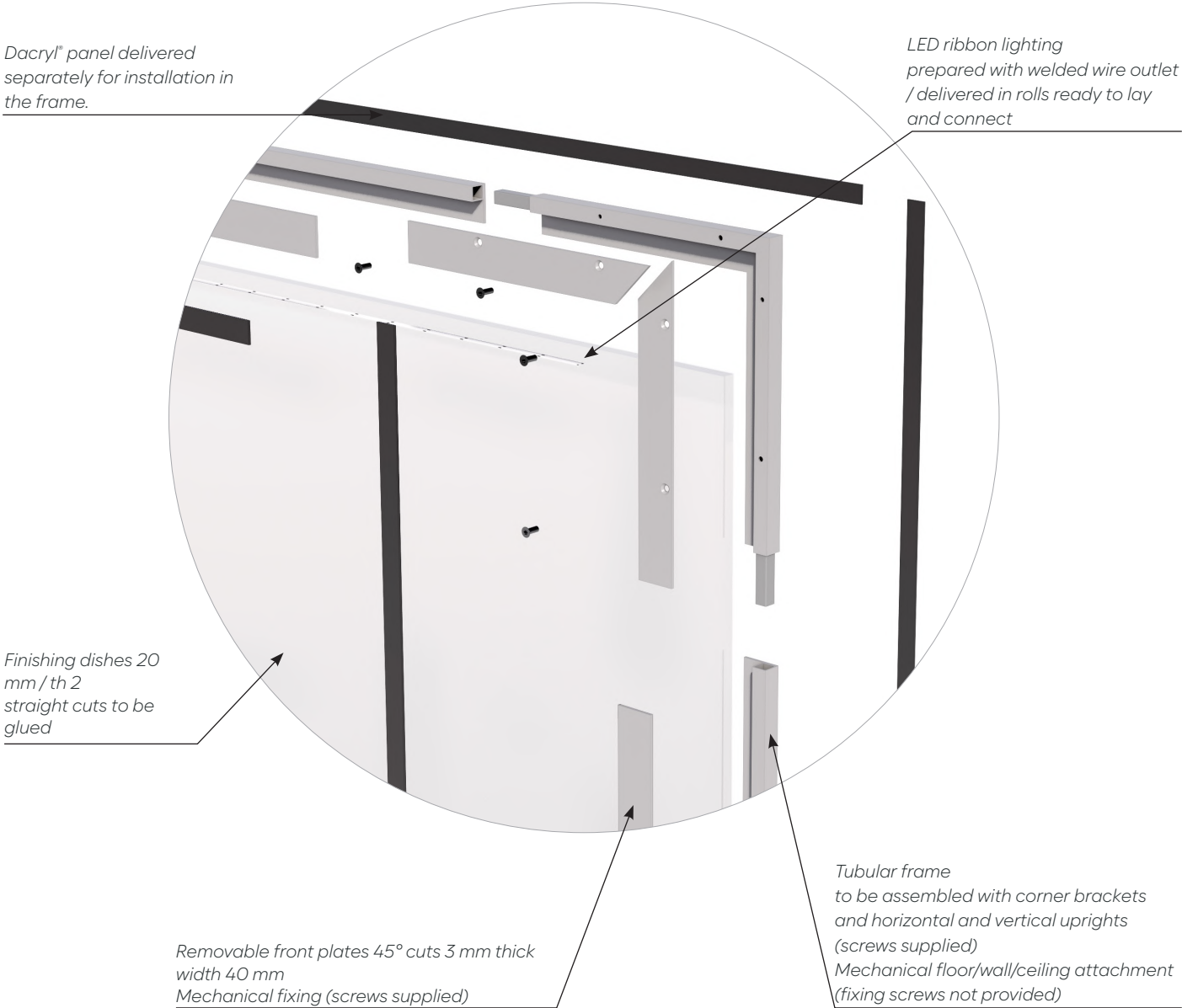

STRAIGHT TUBULAR FRAME: SEVERAL PANELS

Technical drawing ref. D-A

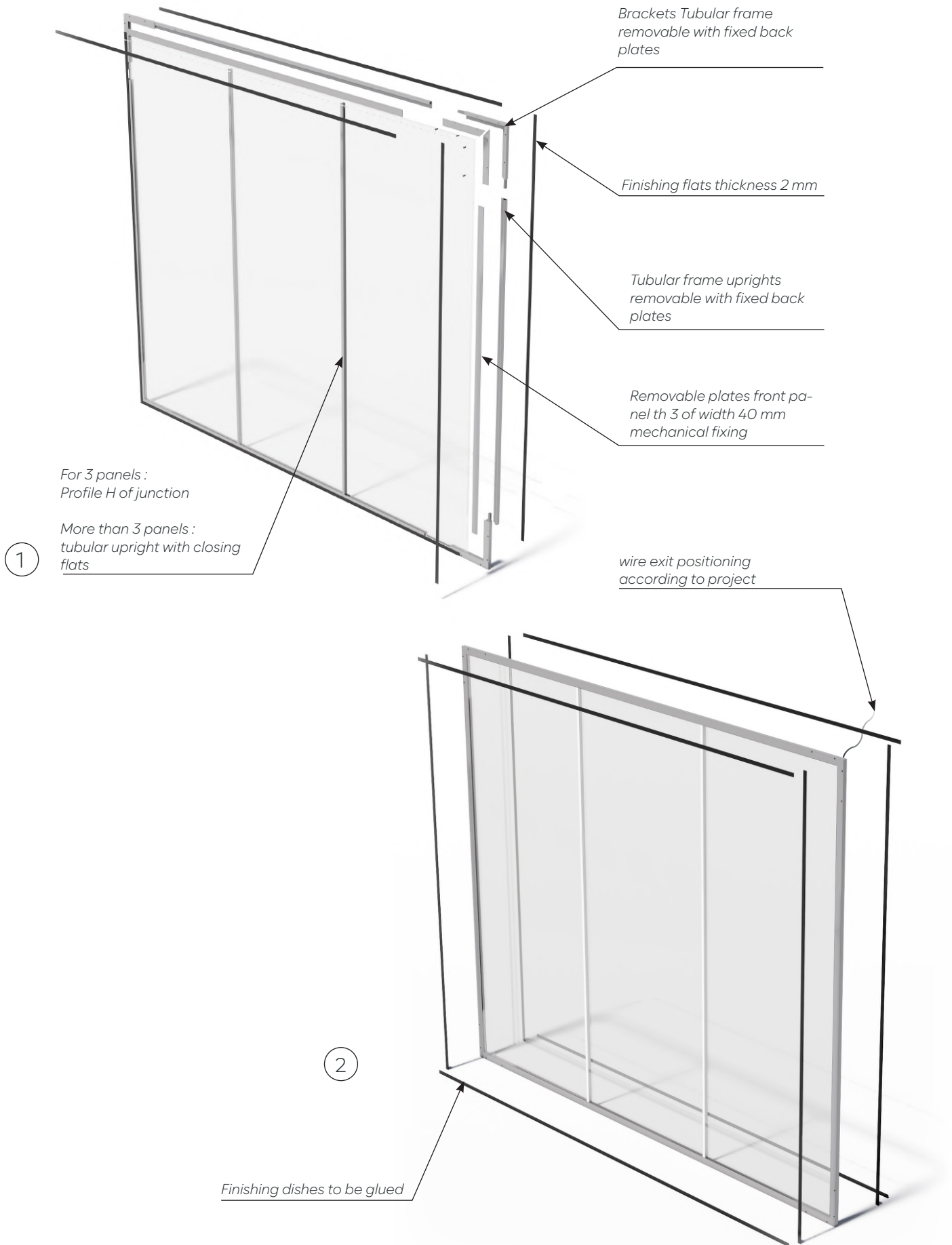

STRAIGHT TUBULAR FRAME: SEVERAL PANELS

Technical drawing ref. D-A

General Informations

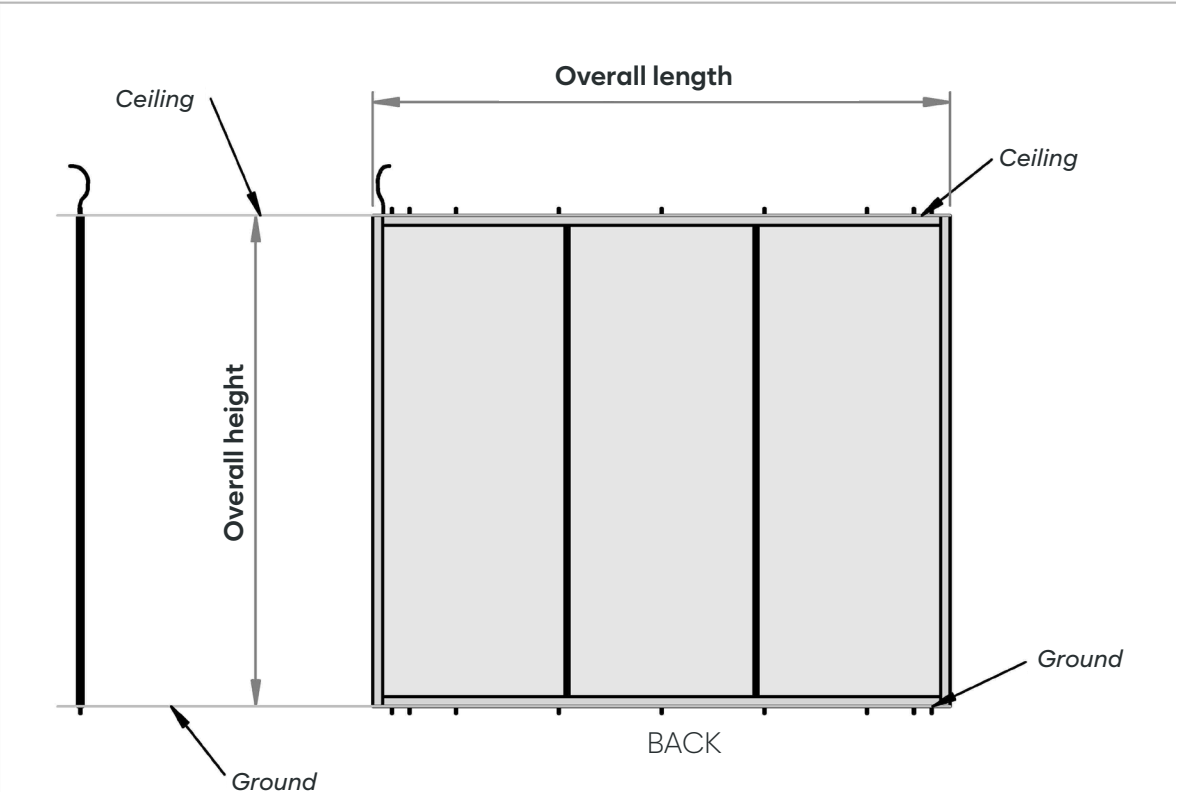
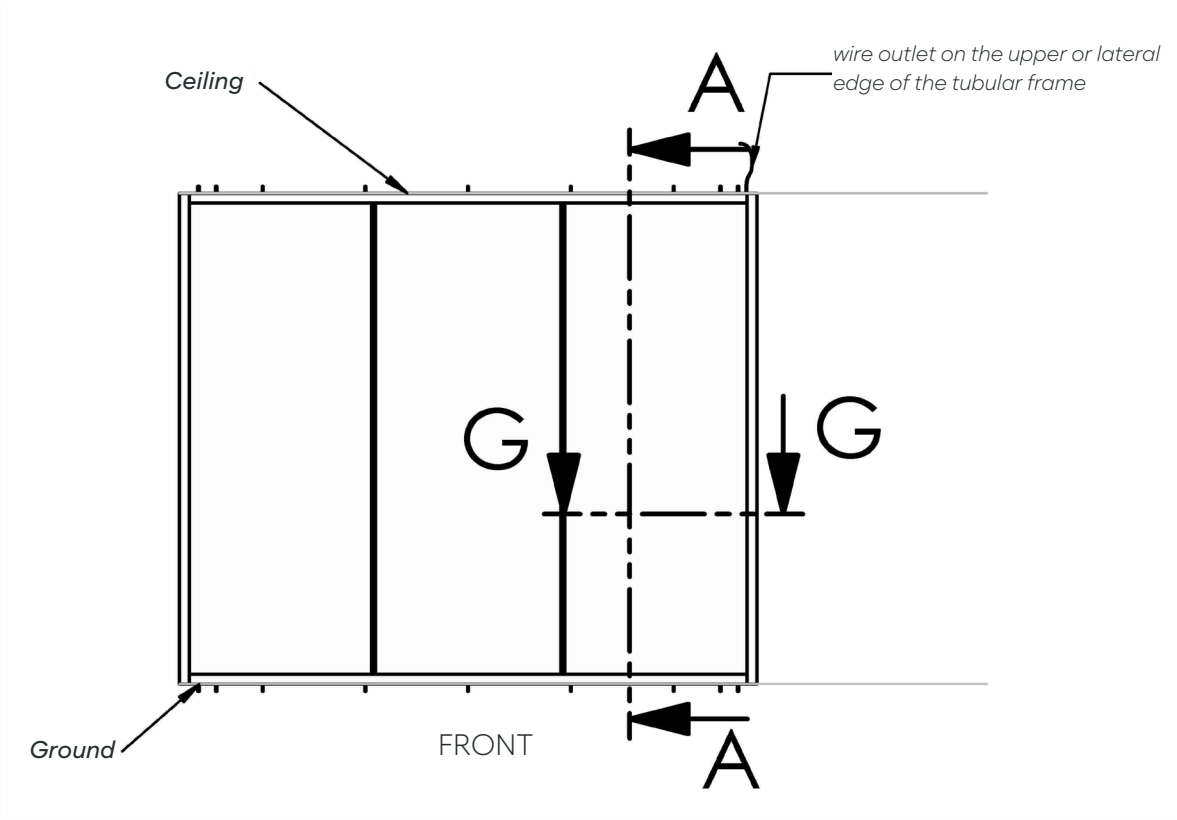

STRAIGHT TUBULAR FRAME: SEVERAL PANELS

Technical drawing ref. D-A

Technical plan product description

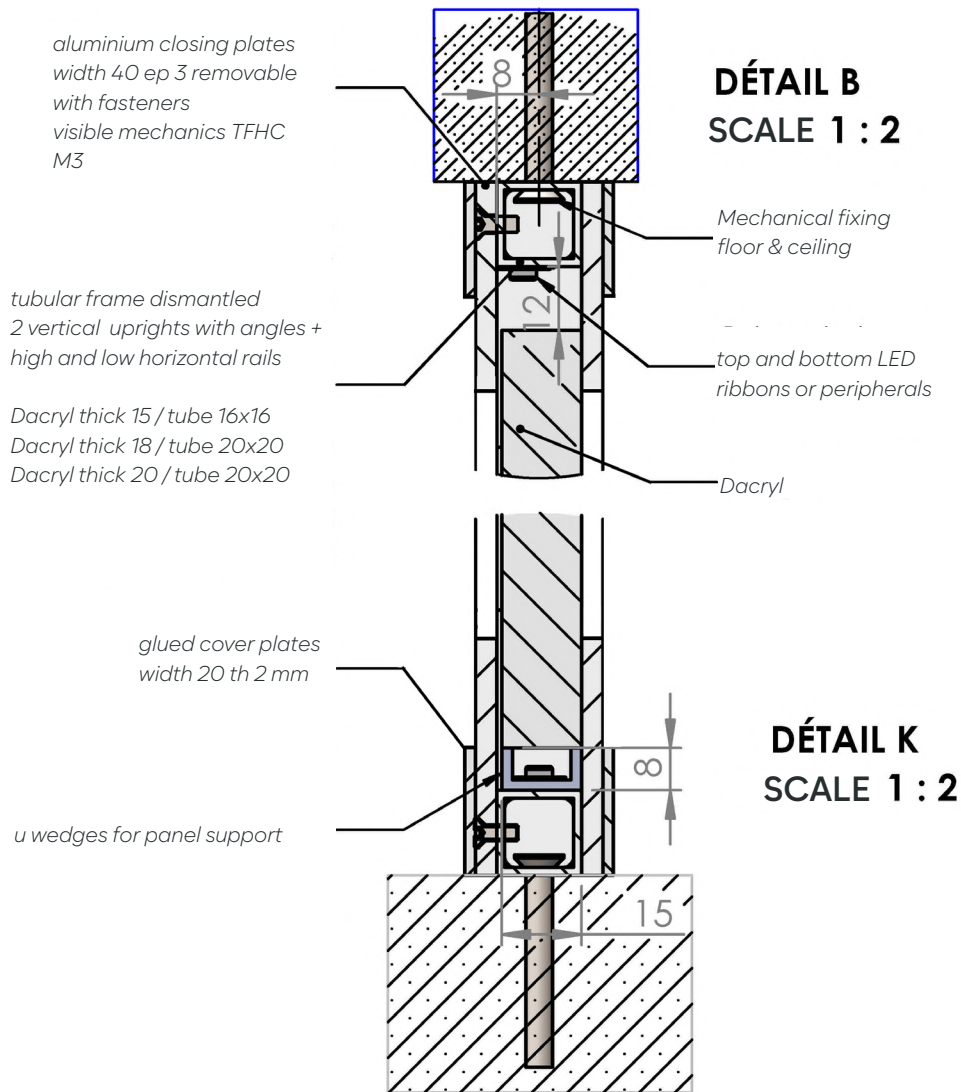

**DÉTAIL I
SCALE 1 : 1**

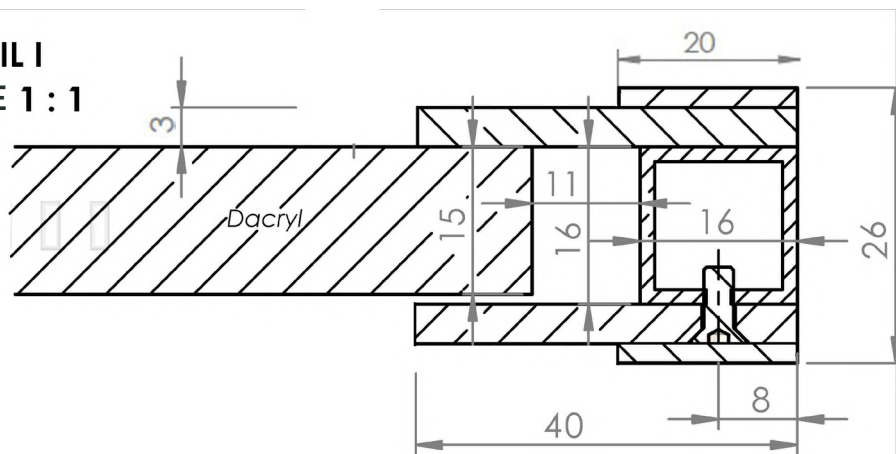

STRAIGHT TUBULAR FRAME: SEVERAL PANELS

Sheet assembly solutions

1

Profile H of junction

For a maximum of 2 to 3 panels
Inclusion Broken Glass Excluded

Sections:

40x20x40 - for Dacryl® th 15 mm

50x25x50 - for Dacryl® th 20 mm

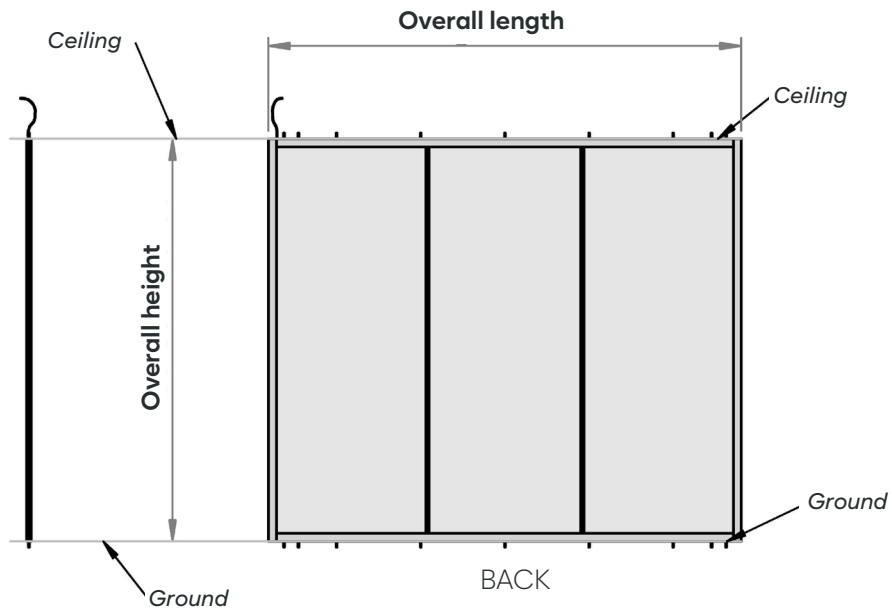

H-junction profile
vertical 2 panels maximum

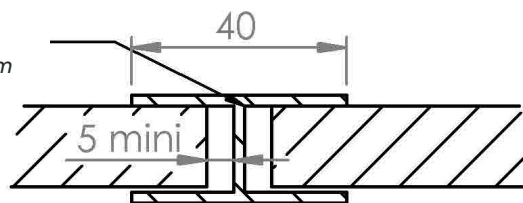

BETWEEN 2 PANELS

DÉTAIL H
SCALE 1 : 2

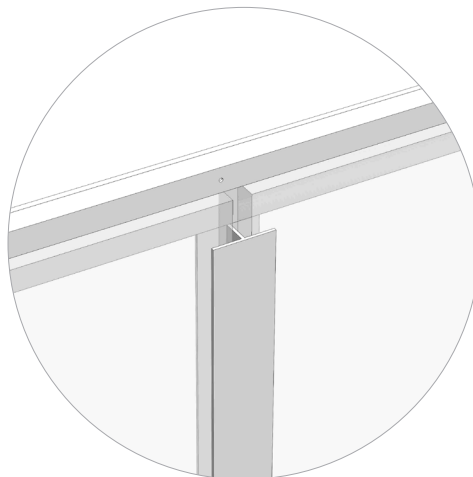

STRAIGHT TUBULAR FRAME: SEVERAL PANELS

Sheet assembly solutions

② Tubular reinforcement for dismountable frames

From 3 panels

Sections:

steel core
16x16 for Dacryl® ép 15
or 20x20 for Dacryl® ép 20

Closing plates 40 mm / th 3
Finishing plates th 2 width 50 mm

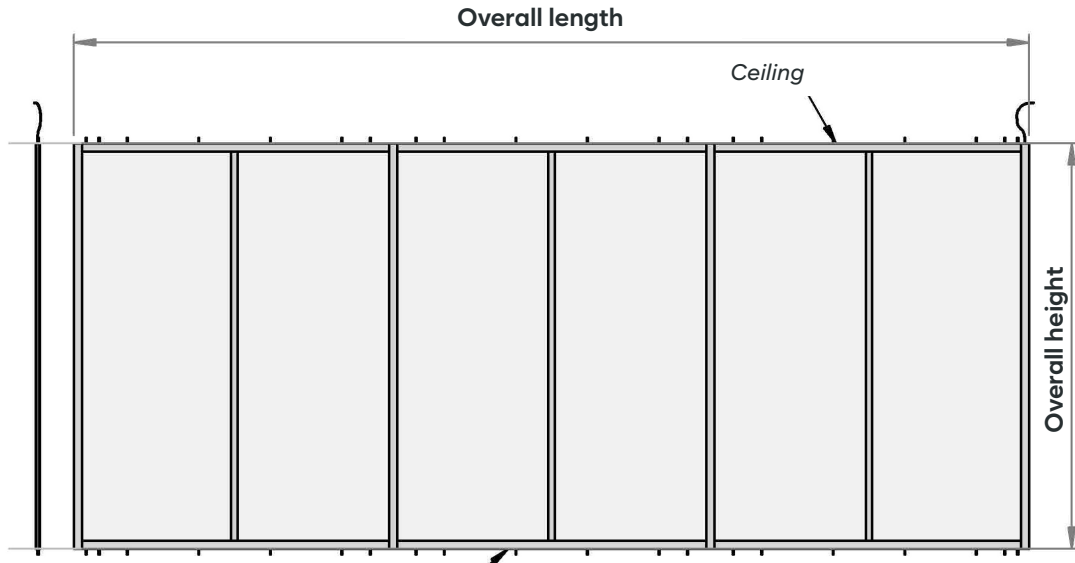

BETWEEN 2 PANELS

vertical tubular reinforcement with 2 returns for assembly for frames composed of more than 2 panels

aluminium closing plates width 40 ép 3 removable with fasteners visible mechanics TFHC M3

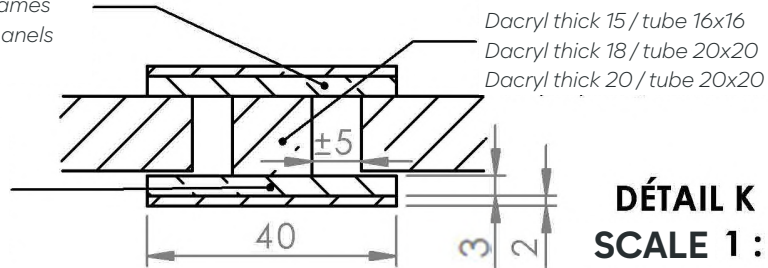

DÉTAIL K
SCALE 1 : 2

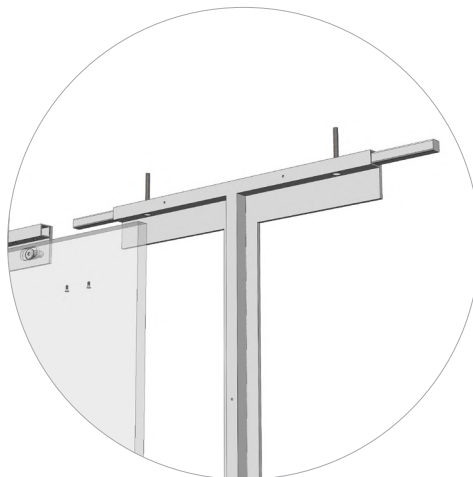

STRAIGHT TUBULAR FRAME: SEVERAL PANELS

Straight Dacryl® set composed of more than 3 Dacryl® panels

Only on consultation for study and costing



Straight tubular frame with pivot door, finish: epoxy



Straight tubular frame, finish: black epoxy

TUBULAR FRAME RIGHT: SEVERAL PANELS ARTWORK

ARTWORK straight Dacryl® set composed of several panels in an art deco spirit.

Only on consultation for study and costing



*Customized Artwork multi-panel tubular
frame, finish: black lacquer*